

1. (Ensure hearing aid is switched off) Plug the Roger X into the Europlug on the side of the installation pad.



6. A solid green light next to the hearing aid indicates successful installation of the RogerDirect receiver code into the Marvel hearing aid.



2. Switch on the Roger installer

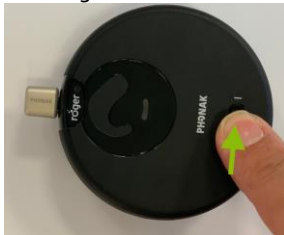

7. Remove hearing aid from the Roger installer pad



3. A solid green light next to the Roger X receiver indicates the Roger X contains a receiver code which is ready to install



8. Switch off the Roger installer pad



4. Turn the hearing aid on and place it on the hearing aid outline on top of the Roger Installer pad.



9. You are ready to connect your Marvel hearing aid to any Roger transmitter



5. The light next to the Roger X receiver will begin blinking green indicating the installation is in process.



**Important:** It is recommended to keep a **minimum of 3m** between each Roger Installer during installation/uninstallation and to keep all **other** hearing aids and Roger devices near the installer pad **turned off**.

*See reverse for the un-installation guide*

1. (Ensure hearing aid is switched off) Plug the Roger X into the Europlug on the side of the installation pad



6. A solid green light next to the Roger X receiver indicates successful transfer of the RogerDirect receiver code back into the Roger X receiver – the hearing aid no longer contain the RogerDirect receiver code



2. Switch on the Roger installer



7. Remove hearing aid from the Roger installer pad



3. No light next to the Roger X receiver indicates the Roger X is empty i.e., has no RogerDirect receiver codes in it



8. Switch off the Roger installer pad



4. Turn the hearing aid on and place the hearing aid on the hearing aid outline on top of the Roger Installer pad



10. The Roger X now has the RogerDirect receiver code back in it and is awaiting installation into the next hearing aid.



5. The light next to the hearing aid will begin blinking green indicating the un-installation is in process



**Important:** It is recommended to keep a **minimum of 3m** between each Roger Installer during installation/uninstallation and to keep all **other** hearing aids and Roger devices near the installer pad **turned off**.

*See reverse for the installation guide*