

1. (Ensure hearing aid is switched off) Switch on the Roger Select iN transmitter



6. Turn the hearing aid on and place the hearing aid next to the Roger Select iN transmitter



2. Check that there are any receiver codes available in the Roger Select iN by **briefly** pushing the pin tool into the button hole farthest from the S/N

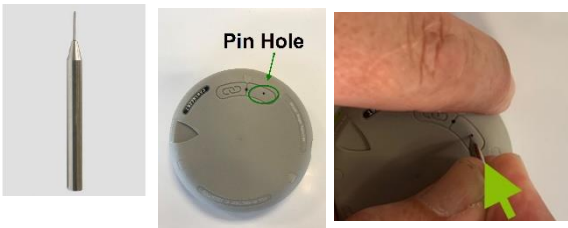

7. A solid green light indicates successful installation of one RogerDirect receiver code into the hearing aid. **This also connects the transmitter to the hearing aid.**



3. The following light indication shows the number of receiver codes available in the iN transmitter e.g. two green flashes = two codes available



8. Restart the Roger Select iN



4. To install a RogerDirect receiver code into a Marvel hearing aid, push the pin tool into the button hole farthest from the S/N and hold it there for **2 Sec**

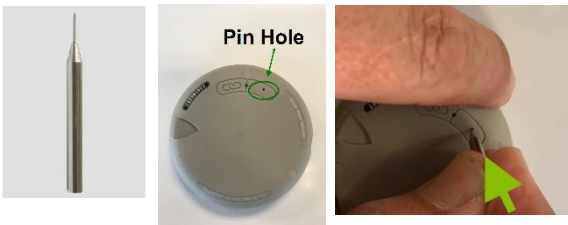

9. Repeat steps 1-8 if a binaural fit.

5. You should see a continuous flashing green light, indicating the iN transmitter is ready to install a RogerDirect receiver code



Important: It is recommended to keep all **other** hearing aids and Roger devices near the Roger Select iN **turned off** during installation.

See reverse for the un-installation guide

1. (Ensure hearing aid is switched off) Switch on the Roger Select iN transmitter



6. Turn the hearing aid on and place the hearing aid next to the Roger Select iN transmitter



2. Check that there are empty slots available for the receiver code in the Roger Select iN by **briefly** pushing the pin tool into the button hole farthest from the S/N.

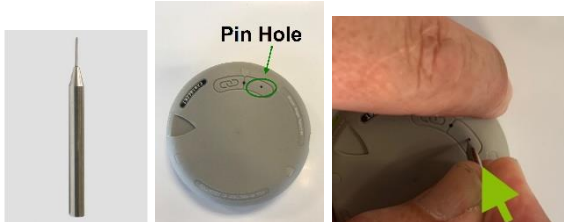

8. A solid green light indicates the successful un-installation of the RogerDirect receiver code from the hearing aid back into the Roger Select iN.



3. The following light indication shows the number of empty slots available in the iN transmitter e.g. one green flash + one red flash = one code + one empty slot available

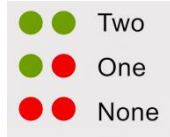

9. Restart Roger Select iN



4. Push the pin tool in the button hole farthest from the S/N and hold it there for **2 Sec.**

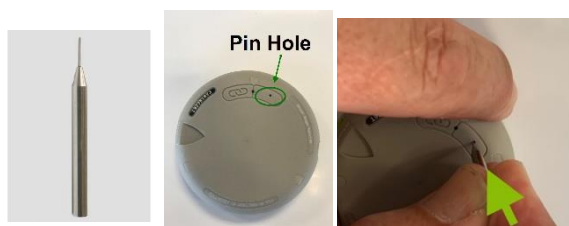

10. Repeat step 2 to check if the code is back in the Roger Select iN.



Repeat steps 4-9 if a binaural fit and wanting to remove the code from the other hearing aid

5. You should see a continuous flashing green light, indicating the iN transmitter it is ready to receive a RogerDirect receiver code from the Marvel hearing aid

